



# Available Enterprise Offices

## West

### **The Metropolis**

Suite 3001 - 28 WS

Suite 3002 - 31 WS

Suite 3003 - 21 WS

### **Razer SEA HQ**

Suite 7002 - 41 WS

## Central

### **Cross Street Exchange**

Suite 2002 - 31 WS

Suite 2067 - 30 WS

Suite 2079 - 21 WS

### **Marina One East Tower**

Suite 05-02 - 85 WS

Suite 05-02B - 42 WS

Suite 05-03 - 34 WS

### **Marina One West Tower**

Suite 5099W - 55 WS

Suite 05-09 - 49 WS

## East

### **Asia Green**

Suite 2001 - 41 WS

Suite 2002 - 25 WS

Suite 2003 - 25 WS

Suite 2005 - 25 WS

Suite 2006 - 34 WS

Suite 2067 - 100 WS

WS - Workstation

A typical workstation includes a desk, an ergonomic chair, and a pedestal.

# JustCo The Metropolis Level 3

Suite 3001 1,720 sq ft 28 workstations

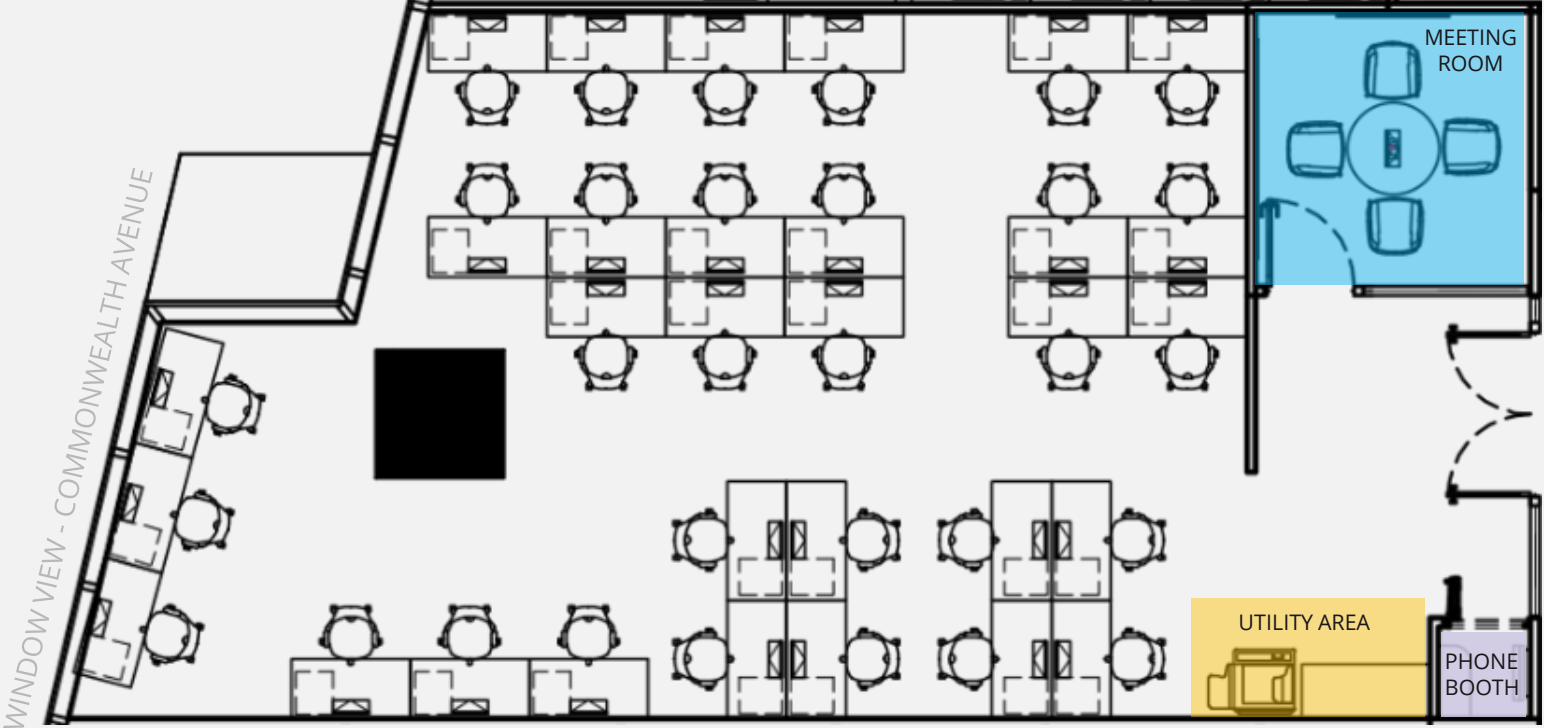

All information in this document is subject to change. Images and floor plans are for reference only.



# JustCo The Metropolis Level 3

Suite 3002 1,670 sq ft 31 workstations

WINDOW VIEW - NORTH BUONA VISTA DRIVE

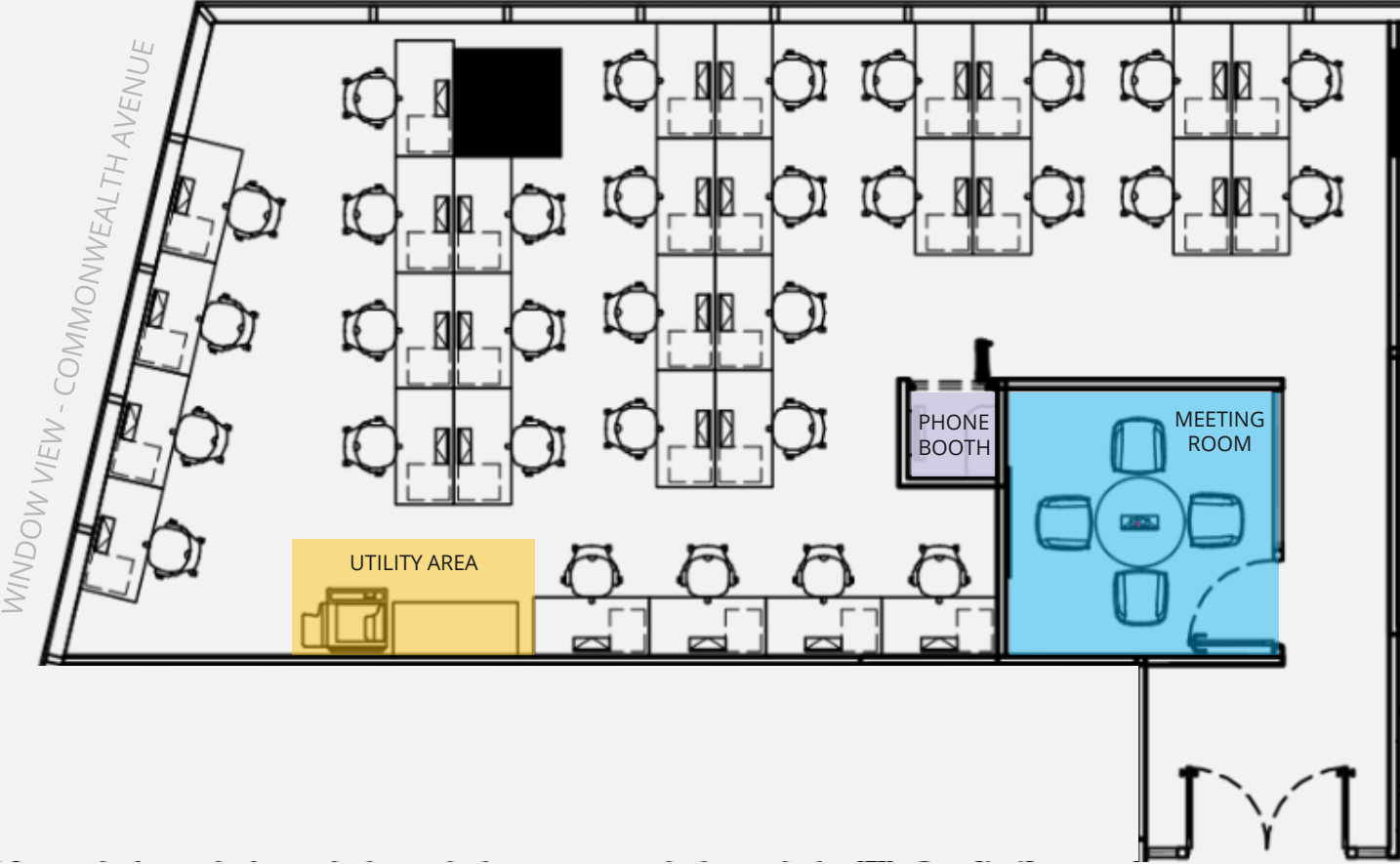

All information in this document is subject to change. Images and floor plans are for reference only.



# JustCo The Metropolis Level 3

Suite 3003 1,270 sq ft 21 workstations

WINDOW VIEW - NORTH BUONA VISTA DRIVE

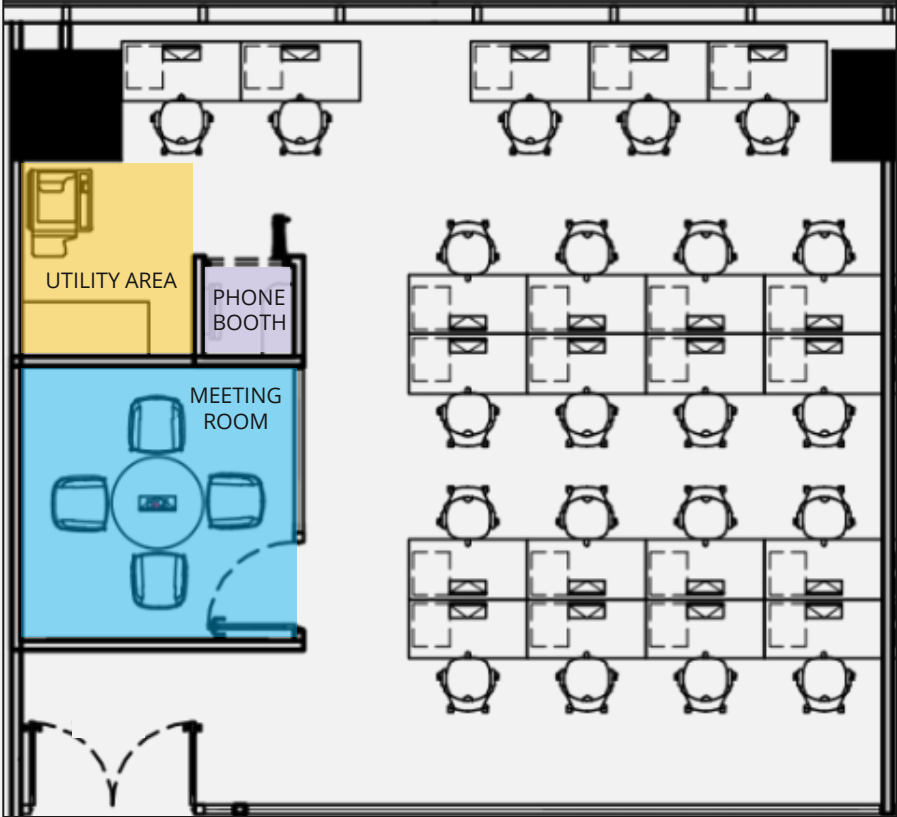

All information in this document is subject to change. Images and floor plans are for reference only.



# JustCo Razer SEA HQ Level 7

Suite 7002 2,530 sq ft 41 workstations

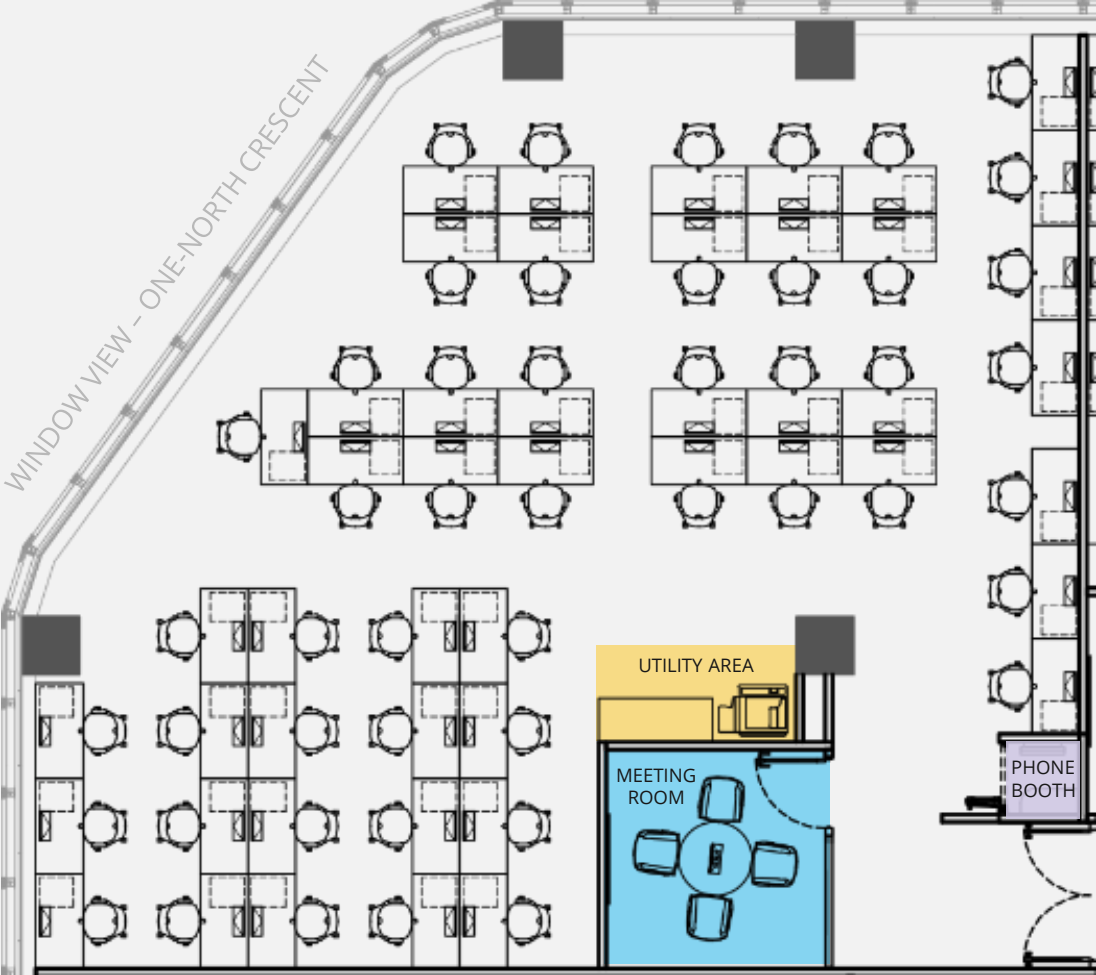

All information in this document is subject to change. Images and floor plans are for reference only.



# JustCo Cross Street Exchange Level 2

Suite 2002 1,570 sq ft 31 workstations

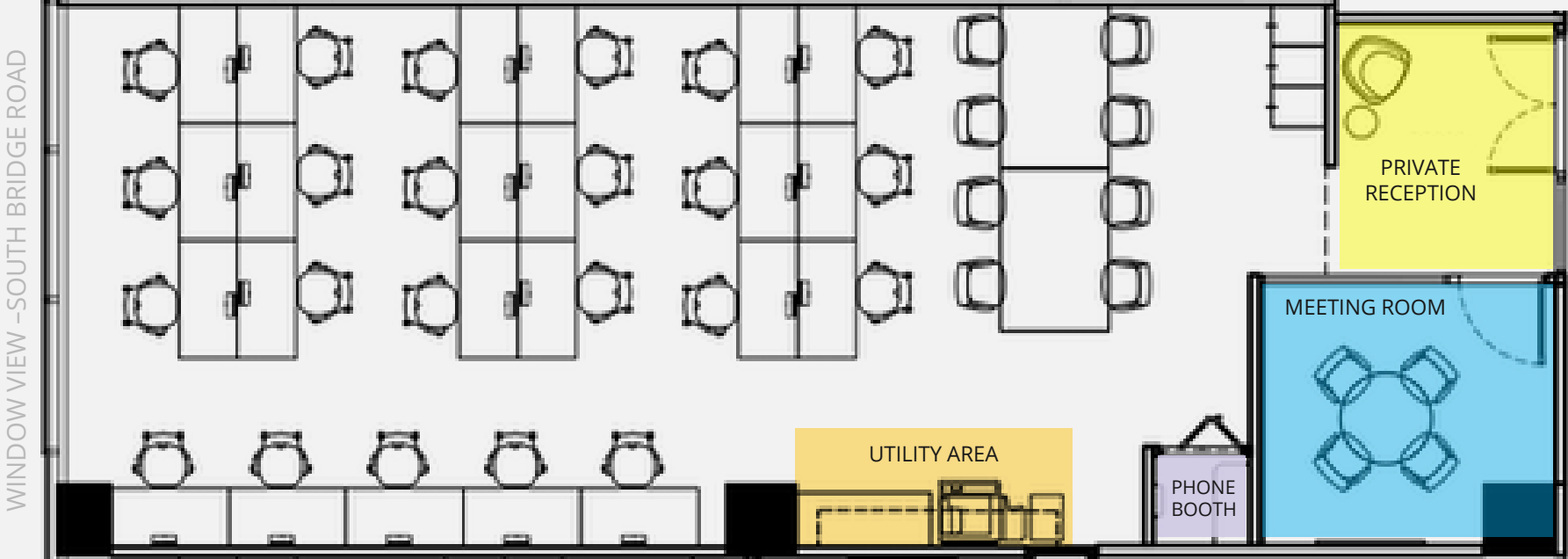

All information in this document is subject to change. Images and floor plans are for reference only.



# JustCo Cross Street Exchange Level 2

Suite 2067 2,080 sq ft 30 workstations

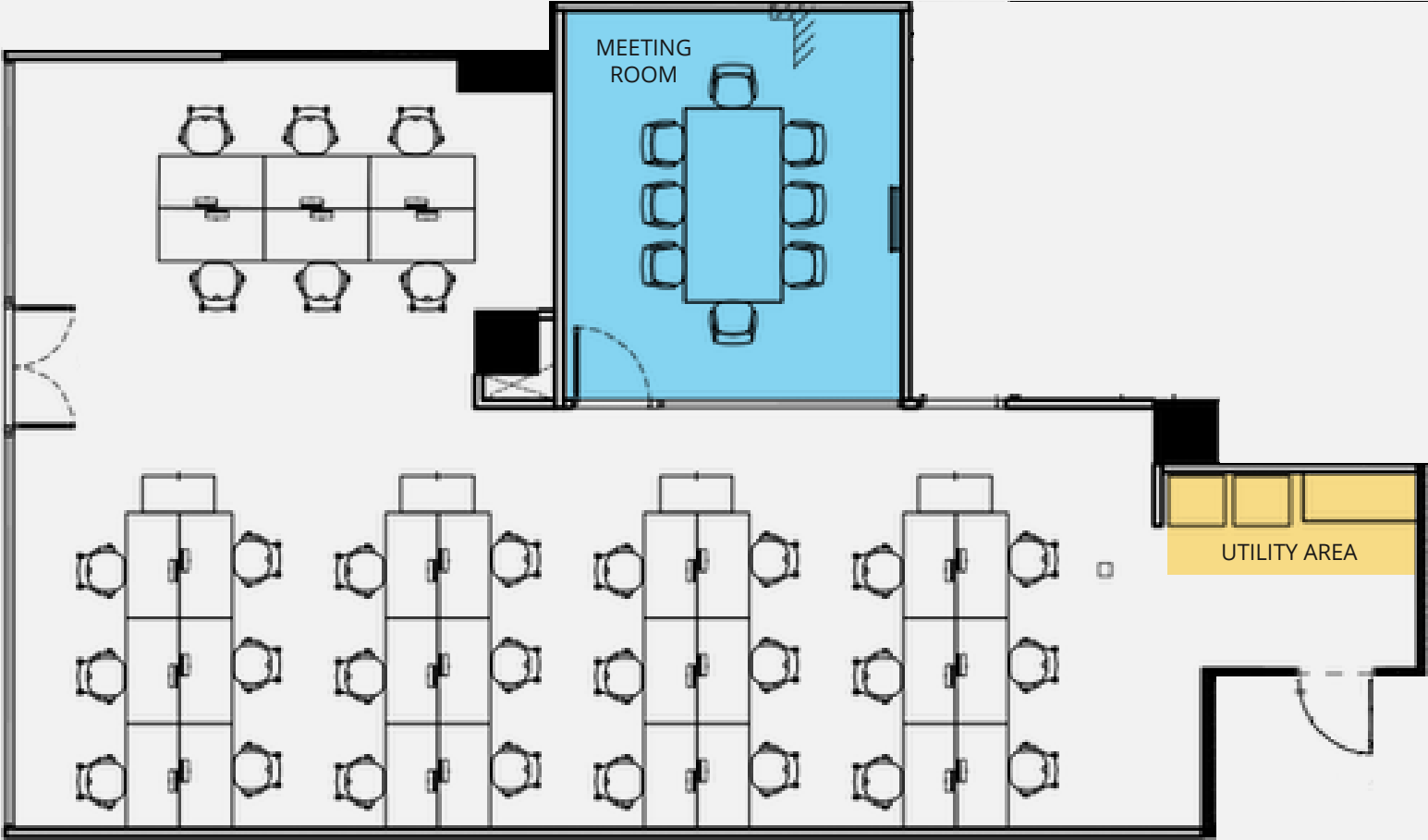

All information in this document is subject to change. Images and floor plans are for reference only.



# JustCo Cross Street Exchange Level 2

Suite 2079 1,410 sq ft 21 workstations

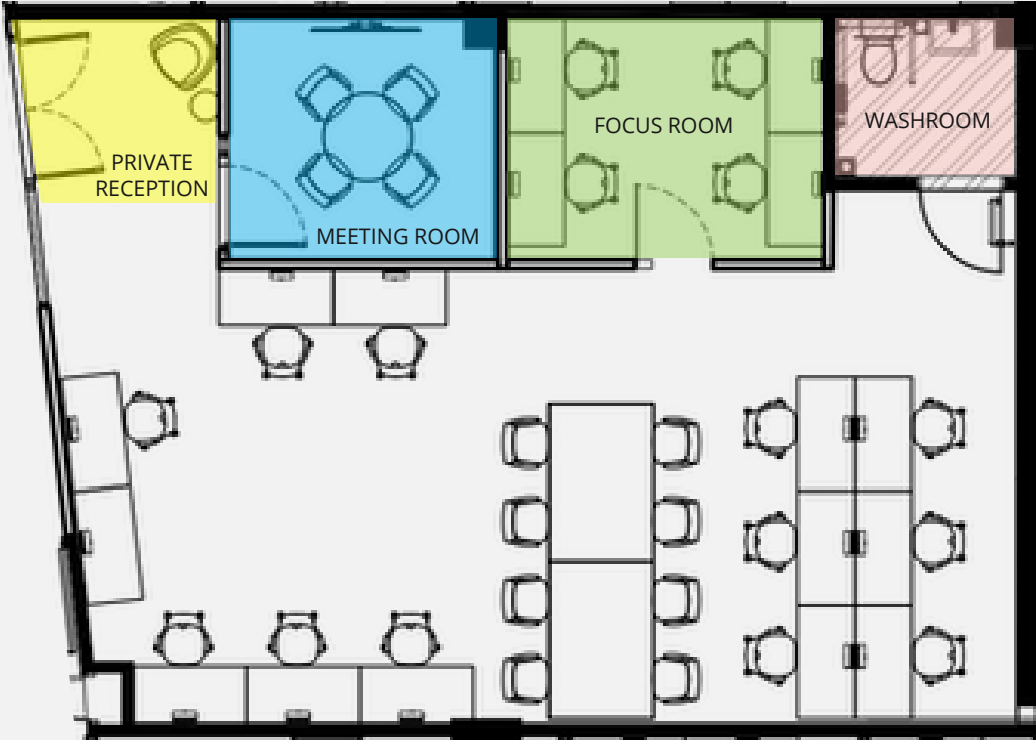

All information in this document is subject to change. Images and floor plans are for reference only.





# JustCo Marina One East Tower Level 5

Suite 05-02 7,910 sq ft 85 workstations

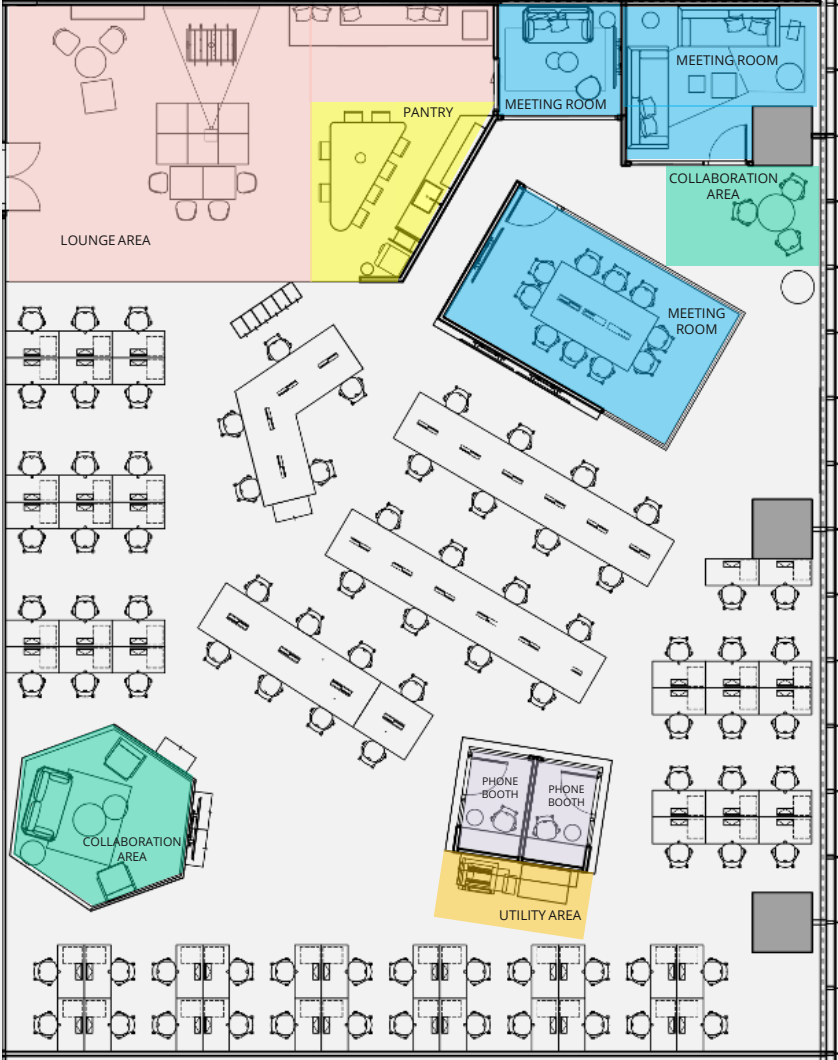

All information in this document is subject to change. Images and floor plans are for reference only.



# JustCo Marina One East Tower Level 5

Suite 05-02B 2,470 sq ft 42 workstations

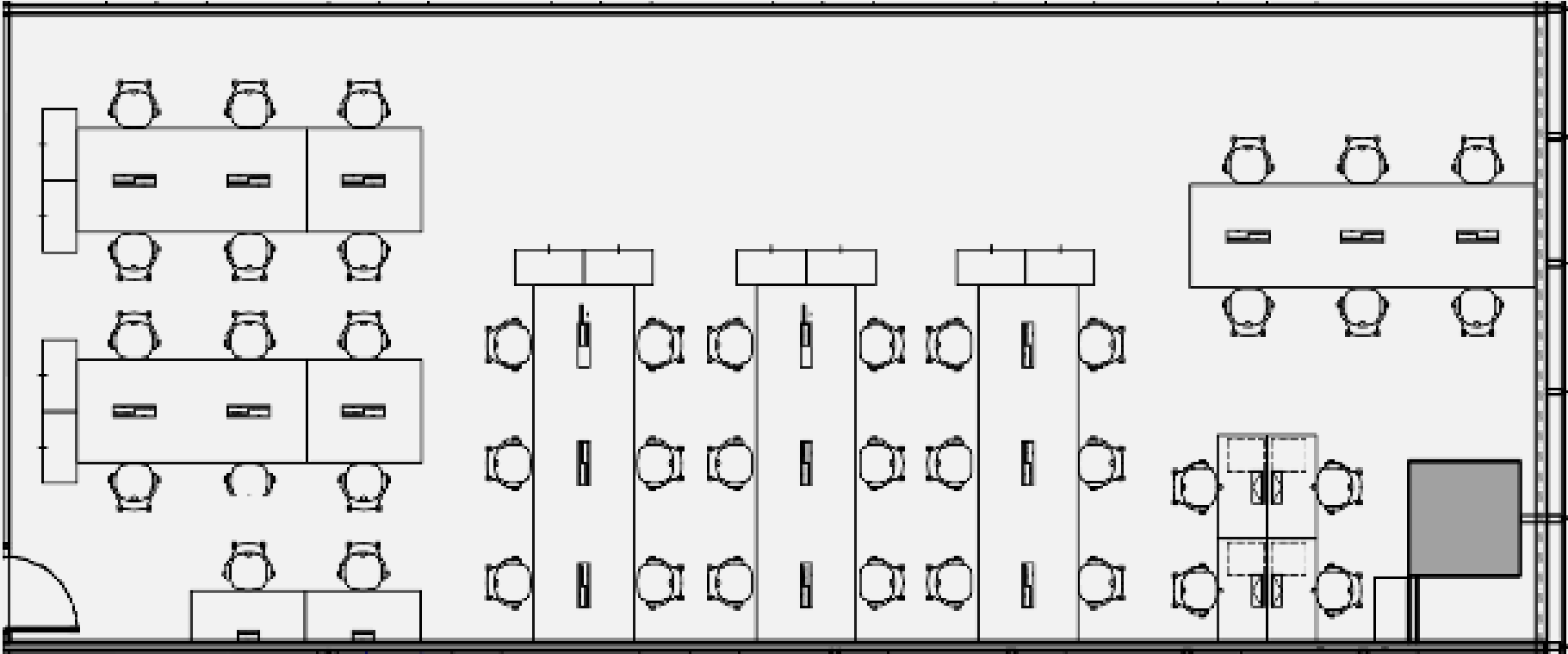

WINDOW VIEW - CENTRAL BLVD

All information in this document is subject to change. Images and floor plans are for reference only.



# JustCo Marina One East Tower Level 5

Suite 05-03 2,500 sq ft 34 workstations

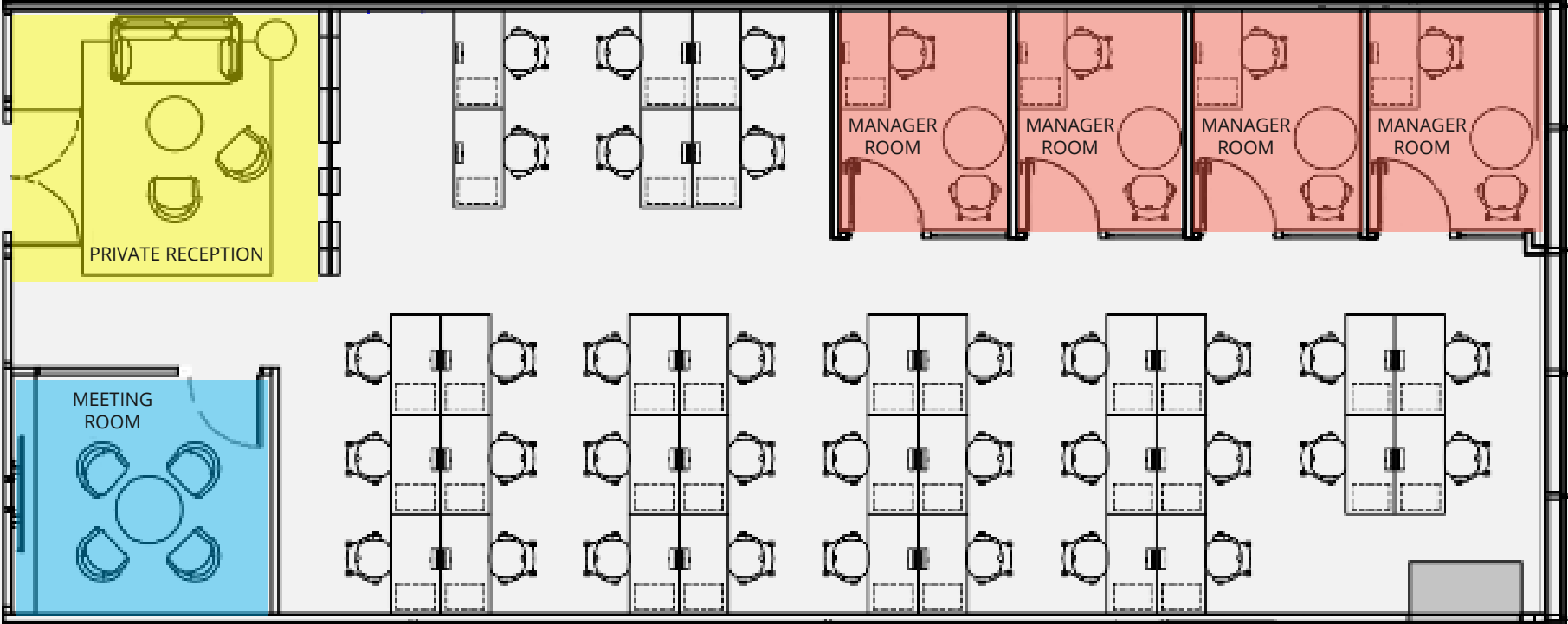

All information in this document is subject to change. Images and floor plans are for reference only.



# JustCo Marina One West Tower Level 5

Suite 5099W 2,730 sq ft 55 workstations

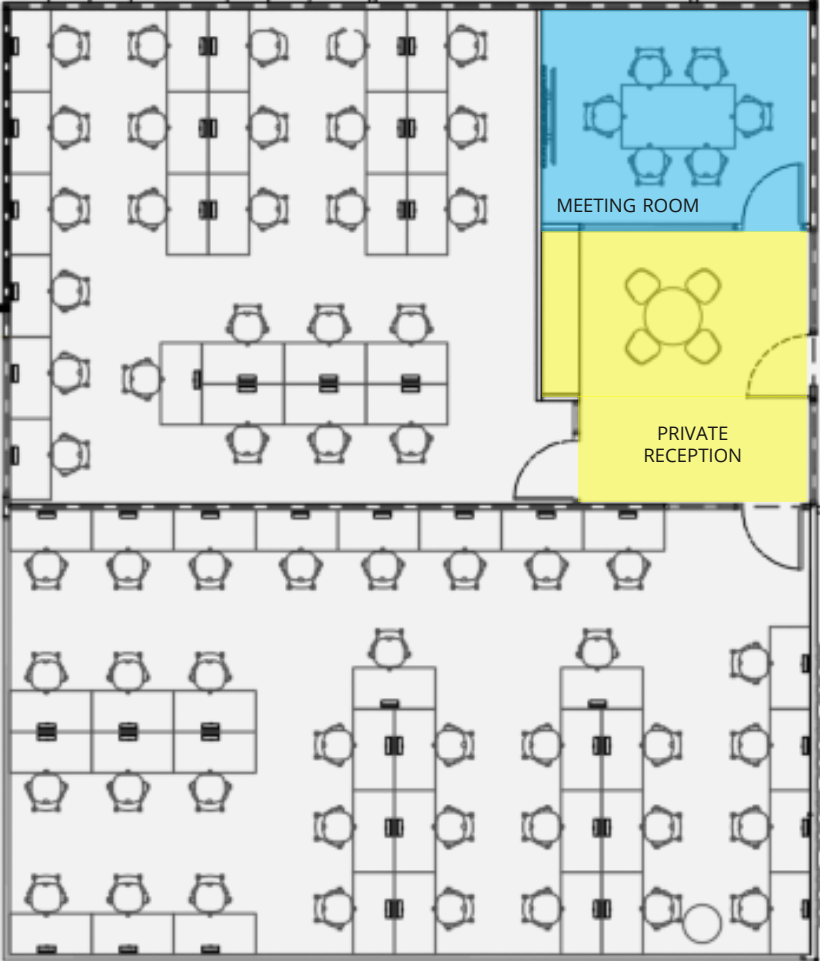

All information in this document is subject to change. Images and floor plans are for reference only.



# JustCo Marina One West Tower Level 5

Suite 05-09 3,540 sq ft 49 workstations

WINDOW VIEW - CENTRAL BLVD

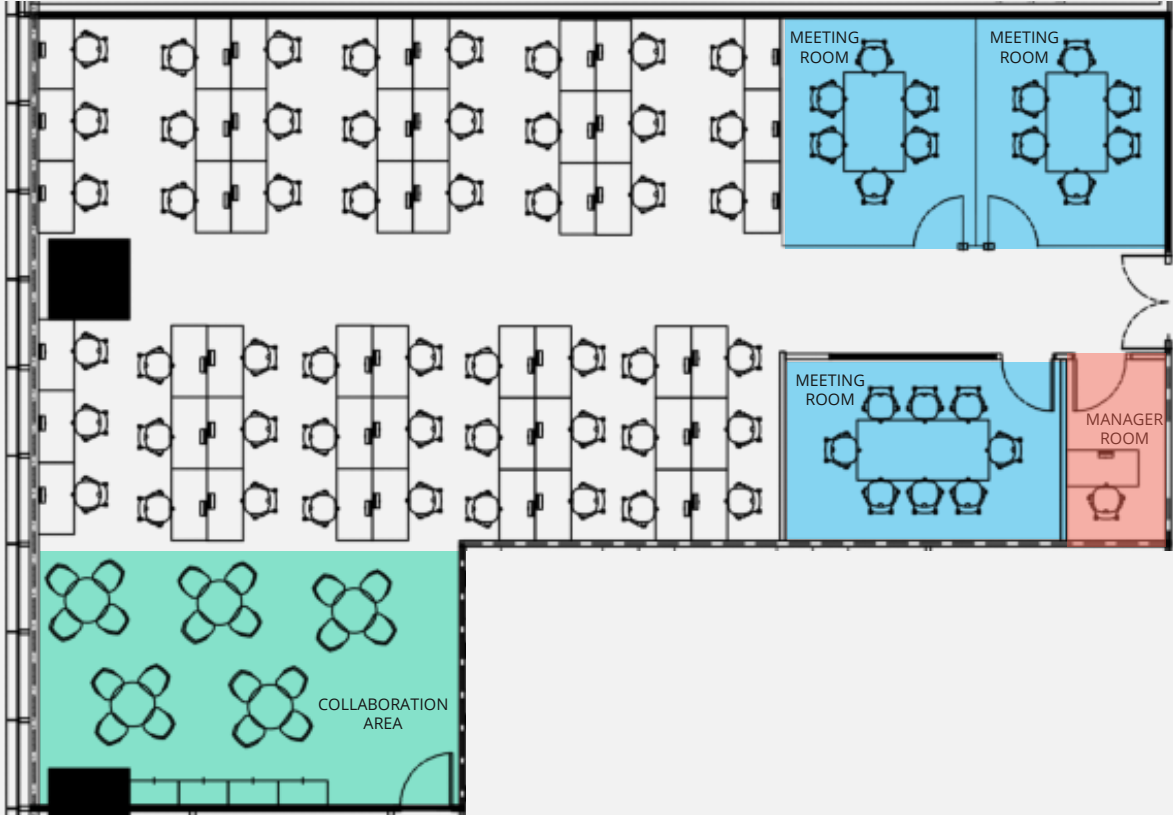

All information in this document is subject to change. Images and floor plans are for reference only.



# JustCo Asia Green Level 2

Suite 2001 2,220 sq ft 41 workstations

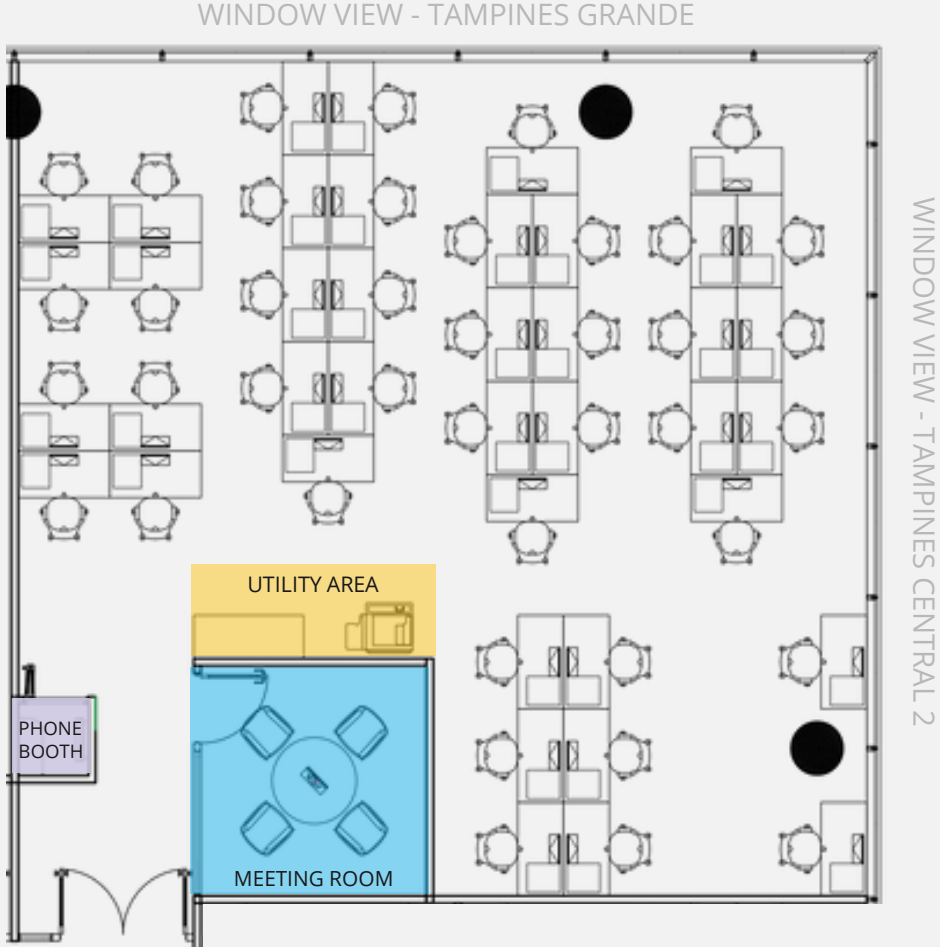

All information in this document is subject to change. Images and floor plans are for reference only.



# JustCo Asia Green Level 2

Suite 2002 1,540 sq ft 25 workstations

WINDOW VIEW - TAMPINES GRANDE

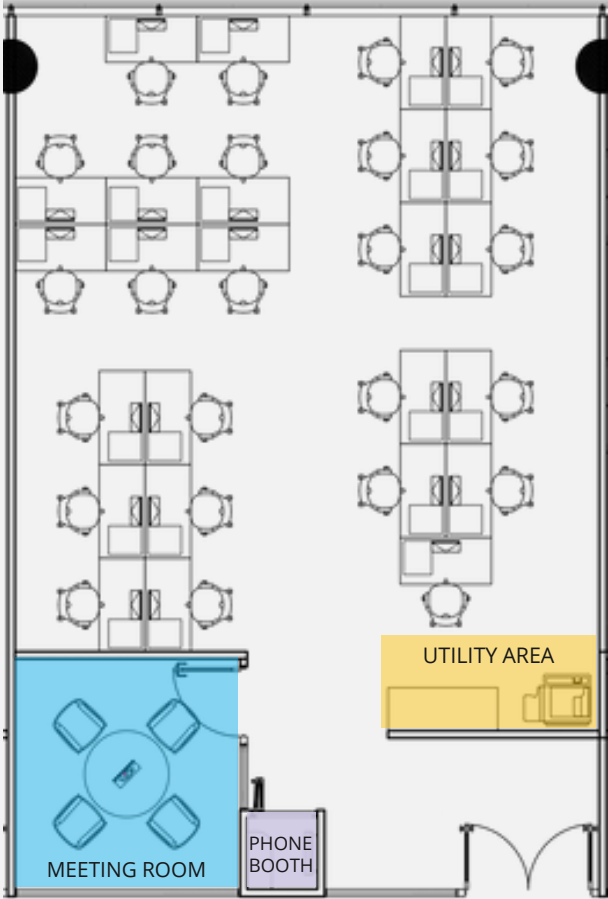

All information in this document is subject to change. Images and floor plans are for reference only.



# JustCo Asia Green Level 2

Suite 2003 1,540 sq ft 25 workstations

WINDOW VIEW - TAMPINES GRANDE

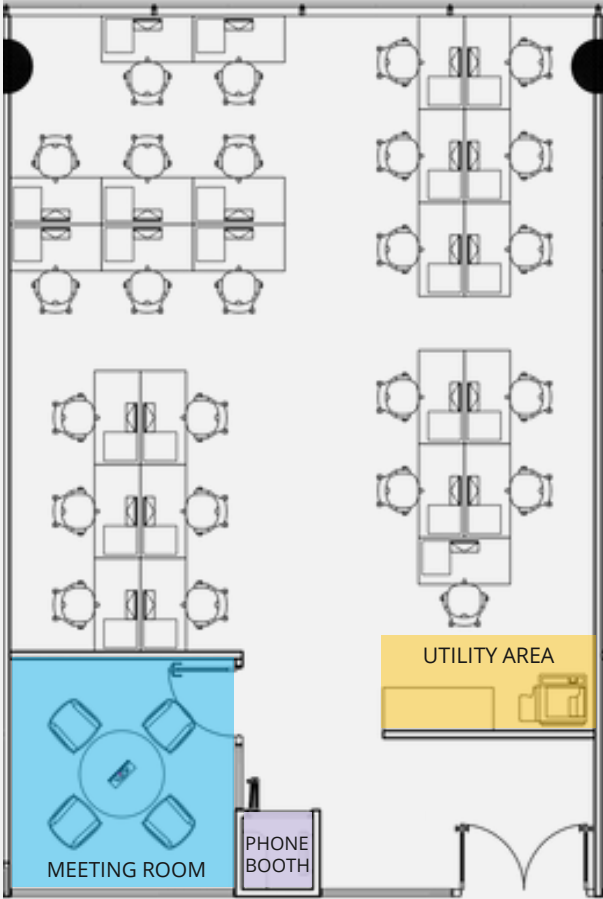

All information in this document is subject to change. Images and floor plans are for reference only.



# JustCo Asia Green Level 2

Suite 2005 1,540 sq ft 25 workstations

WINDOW VIEW - TAMPINES GRANDE

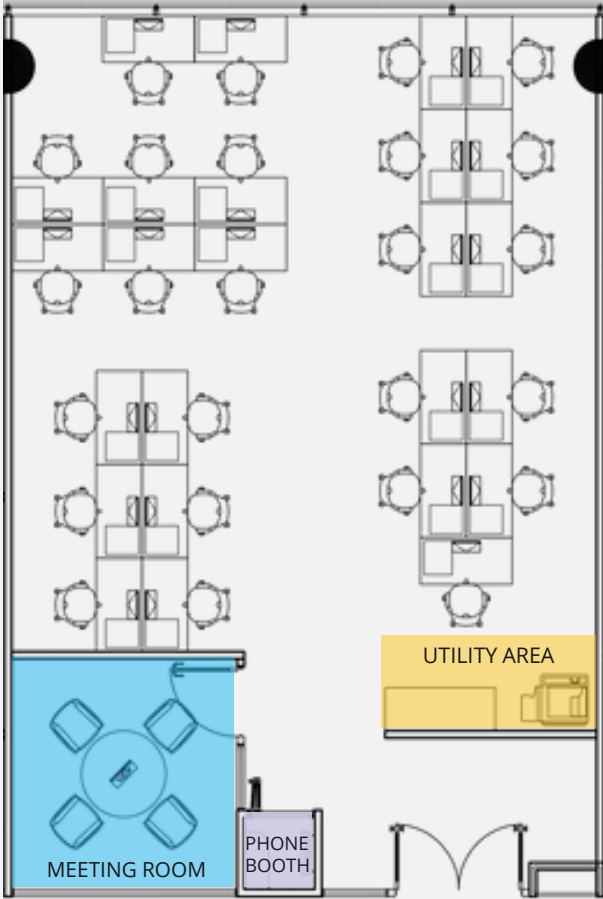

All information in this document is subject to change. Images and floor plans are for reference only.



# JustCo Asia Green Level 2

Suite 2006 1,930 sq ft 34 workstations

WINDOW VIEW - TAMPINES GRANDE

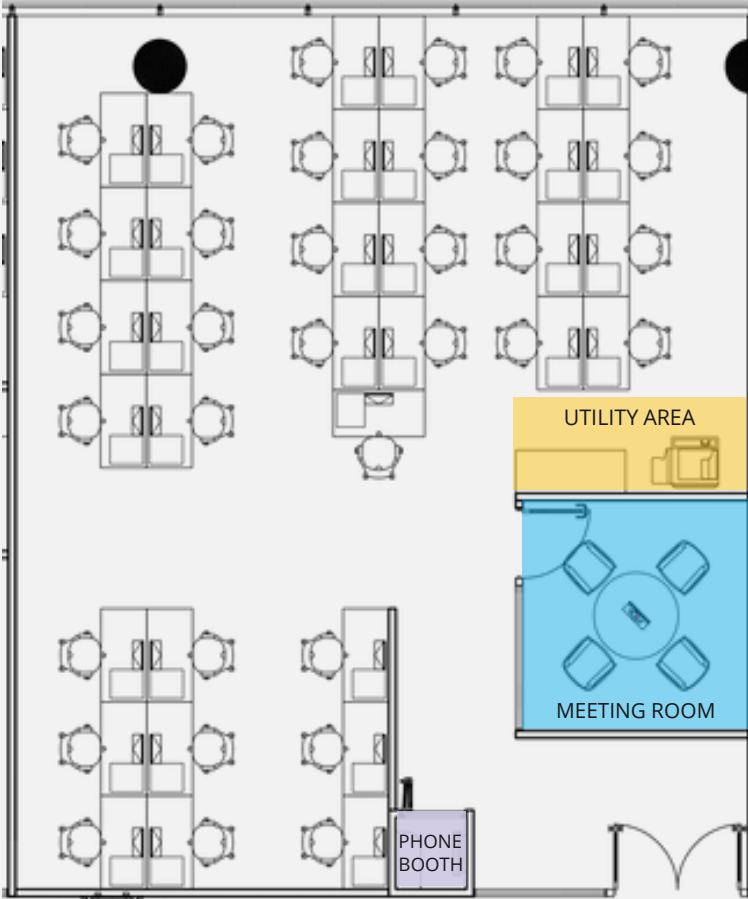

All information in this document is subject to change. Images and floor plans are for reference only.



# JustCo Asia Green Level 2

Suite 2067 4,970 sq ft 100 workstations

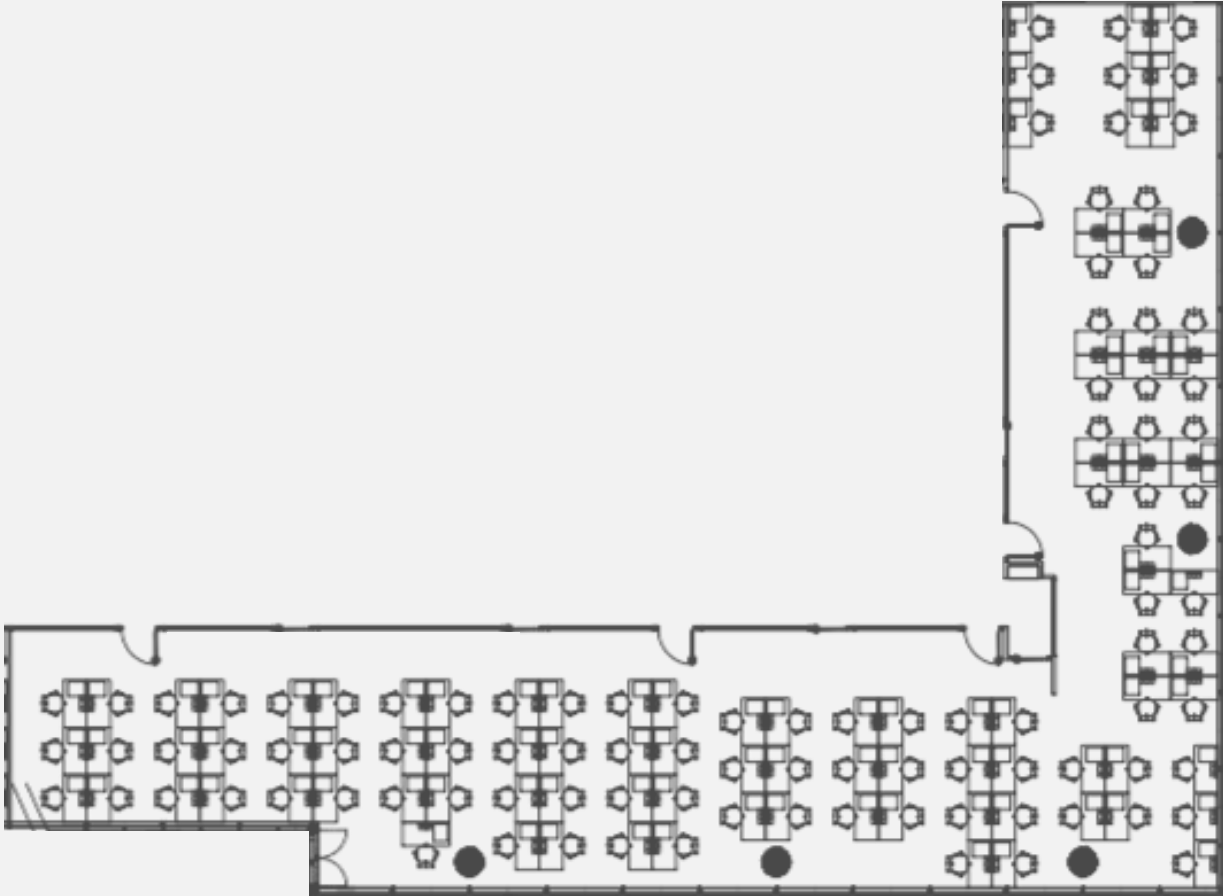

WINDOW VIEW - TAMPINES CENTRAL 2

WINDOW VIEW - TAMPINES AVENUE 5

All information in this document is subject to change. Images and floor plans are for reference only.

